

## Ratcheting Crowfoot Wrenches

### SPEED



Ratcheting open end allows you to advance the nut without removing the wrench from the fastener

### STRENGTH



The ratcheting crowfoot design exceeds ASME requirements for torque performance

### ACCESS



Use with an extension to reach hard to access nuts or when there is not enough clearance to use a ratchet

The GearWrench Ratcheting Crowfoot Wrenches provide improved access to nuts and bolts located in hard to reach places or confined spaces. Used with a 3/8" extension, these ratcheting wrenches allow you to avoid obstructions which limit access or prevent the use of a ratchet, so you can get the job done.



### Access

- Use with 3/8" drive extensions to access hard to reach fasteners
- Use when there is not sufficient space to use a ratchet
- Open end wrench allows access to fasteners when there are height restrictions

### Strength

- Exceeds ASME requirements for torque performance

### Speed

- Quickly ratchet nuts and bolts without removing the wrench from the fastener
- Arrow stamped on head quickly identifies direction of rotation

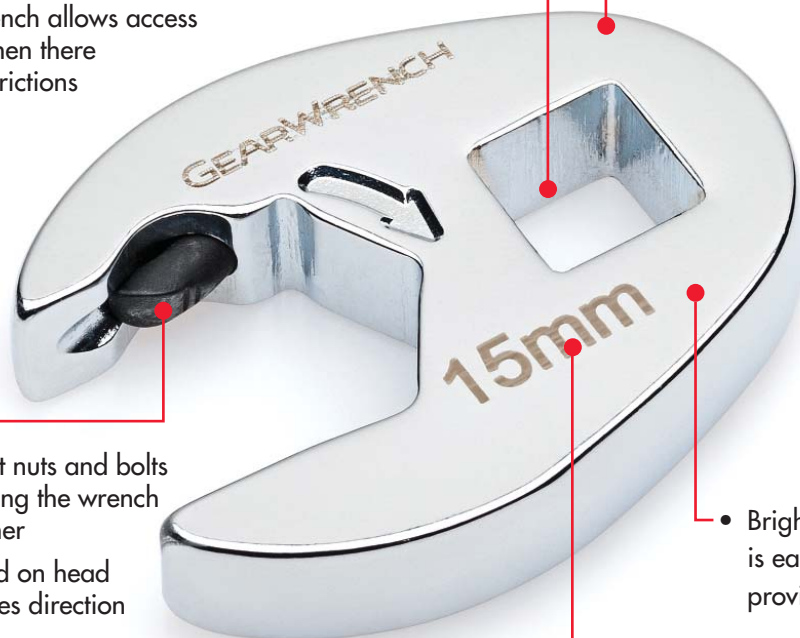

- Size laser etched on both sides of head for easy identification

- Bright Chrome finish is easy to clean and provides high visibility

## Ratcheting Crowfoot Wrenches

### Ratcheting Crowfoot Wrenches - Open Stock

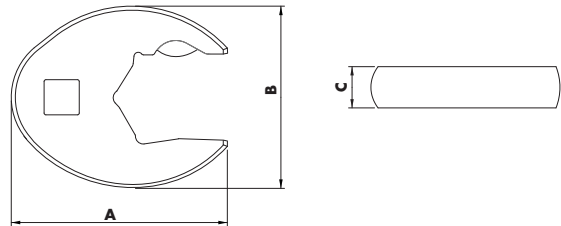

PART NO.	DESCRIPTION	LENGTH (A) (inches)	WIDTH (B) (inches)	HEIGHT (C) (inches)	WEIGHT (lbs.)
89120	3/8" Drive Ratcheting Crowfoot Wrench 3/8"	1.378	0.909	0.224	0.044
89121	3/8" Drive Ratcheting Crowfoot Wrench 7/16"	1.417	0.988	0.252	0.052
89122	3/8" Drive Ratcheting Crowfoot Wrench 1/2"	1.575	1.134	0.319	0.090
89123	3/8" Drive Ratcheting Crowfoot Wrench 9/16"	1.654	1.244	0.327	0.100
89124	3/8" Drive Ratcheting Crowfoot Wrench 5/8"	1.772	1.350	0.346	0.121
89125	3/8" Drive Ratcheting Crowfoot Wrench 11/16"	1.890	1.476	0.362	0.135
89126	3/8" Drive Ratcheting Crowfoot Wrench 3/4"	2.047	1.602	0.374	0.185
89127	3/8" Drive Ratcheting Crowfoot Wrench 13/16"	2.205	1.803	0.425	0.240
89128	3/8" Drive Ratcheting Crowfoot Wrench 7/8"	2.283	1.866	0.449	0.288
89129	3/8" Drive Ratcheting Crowfoot Wrench 15/16"	2.362	1.992	0.465	0.321
89130	3/8" Drive Ratcheting Crowfoot Wrench 1"	2.441	2.087	0.476	0.335
89140	3/8" Drive Ratcheting Crowfoot Wrench 10mm	1.378	0.909	0.224	0.046
89141	3/8" Drive Ratcheting Crowfoot Wrench 11mm	1.417	0.988	0.252	0.052
89142	3/8" Drive Ratcheting Crowfoot Wrench 12mm	1.496	1.094	0.291	0.075
89143	3/8" Drive Ratcheting Crowfoot Wrench 13mm	1.575	1.134	0.319	0.088
89144	3/8" Drive Ratcheting Crowfoot Wrench 14mm	1.654	1.244	0.327	0.098
89145	3/8" Drive Ratcheting Crowfoot Wrench 15mm	1.693	1.331	0.327	0.113
89146	3/8" Drive Ratcheting Crowfoot Wrench 16mm	1.772	1.350	0.346	0.119
89147	3/8" Drive Ratcheting Crowfoot Wrench 17mm	1.890	1.476	0.362	0.144
89148	3/8" Drive Ratcheting Crowfoot Wrench 18mm	1.969	1.539	0.370	0.167
89149	3/8" Drive Ratcheting Crowfoot Wrench 19mm	2.047	1.602	0.374	0.177

### Ratcheting Crowfoot Wrenches - Sets



PART NO.	PRODUCT NAME	CONTENTS
89118	11-PC Ratcheting Crowfoot Set – SAE	3/8", 7/16", 1/2", 9/16", 5/8", 11/16", 3/4", 13/16", 7/8", 15/16", 1"
89119	10-PC Ratcheting Crowfoot Set - Metric	10, 11, 12, 13, 14, 15, 16, 17, 18, 19mm