



North American Headquarters
 601 Rayovac Drive
 Madison, WI 53711
 Telephone 1-800-331-4522
 Internet www.rayovac.com

Marketing Data Sheet - Batteries

S6600176
 Issue A
 Memo No:

Rayovac Stock Number: **AL-D Battery**

Name: **AL-D Alkaline**

Engineering Parameters:

Cell Chemistry:

Alkaline Manganese Dioxide

Designation:

ANSI/NEDA – 13A (AA), IEC – LR20

Nominal Voltage:

1.5 volts

Approximate Weight:

5.3 Oz (150 grams)

Approximate Volume:

3.4 CU IN (56 cc)

Operating Temp. Range:

-30° C to 55° C (-20° F to 130° F)

Terminals: Flashlight

Shell: Plastic

Environmental:

Meets Environmental Protection Agency (EPA)

Requirements For Landfill Disposal.

No Mercury Added Formulation

[Rayovac Alkaline Material Data Safety Sheets](#)

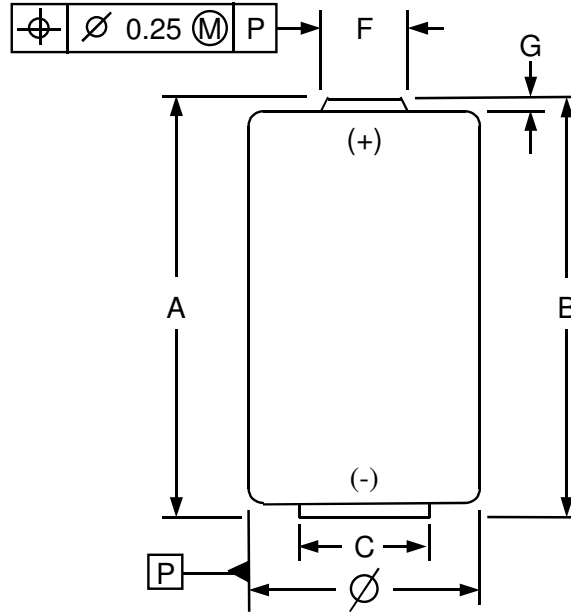

Dimensions	Millimeters	Inches
A (Max)	61.5	2.421
B (Min)	59.5	2.343
C (Min)	18.0	0.709
E (Max)	1.0	0.039
F (Max)	9.5	0.374
G (Min)	1.5	0.059
Ø (Max)	34.2	1.346
Ø (Min)	32.3	1.272

Service life guidelines and representative discharge curves are shown on the following page.

Typical Initial Service Life

Application and Duty Cycle	Discharge Load	Midpoint Current (mA @ 1.2V)	Cut-off Voltage	Service	Units	Discharge Capacity (mAh)
Lighting 4 min/15 min, 8hr/day	1.5 Ω	764	0.9	16.2	hours	12375
Lighting 4 min/hr, 8hr/day	2.2 Ω	545	0.9	24.6	hours	13400
Lighting, Continuous burn	2.2 Ω	530	0.9	20.2	hours	10700
Toy 1 hr/day	2.2 Ω	530	0.8	26.9	hours	14250
Portable Stereo 2 hrs/day	600 mA	600	0.9	19.1	hours	11460
Radio 4 hrs/day	10 Ω	126	0.9	132	hours	16630

Typical Discharge Characteristics at 21C (70F)

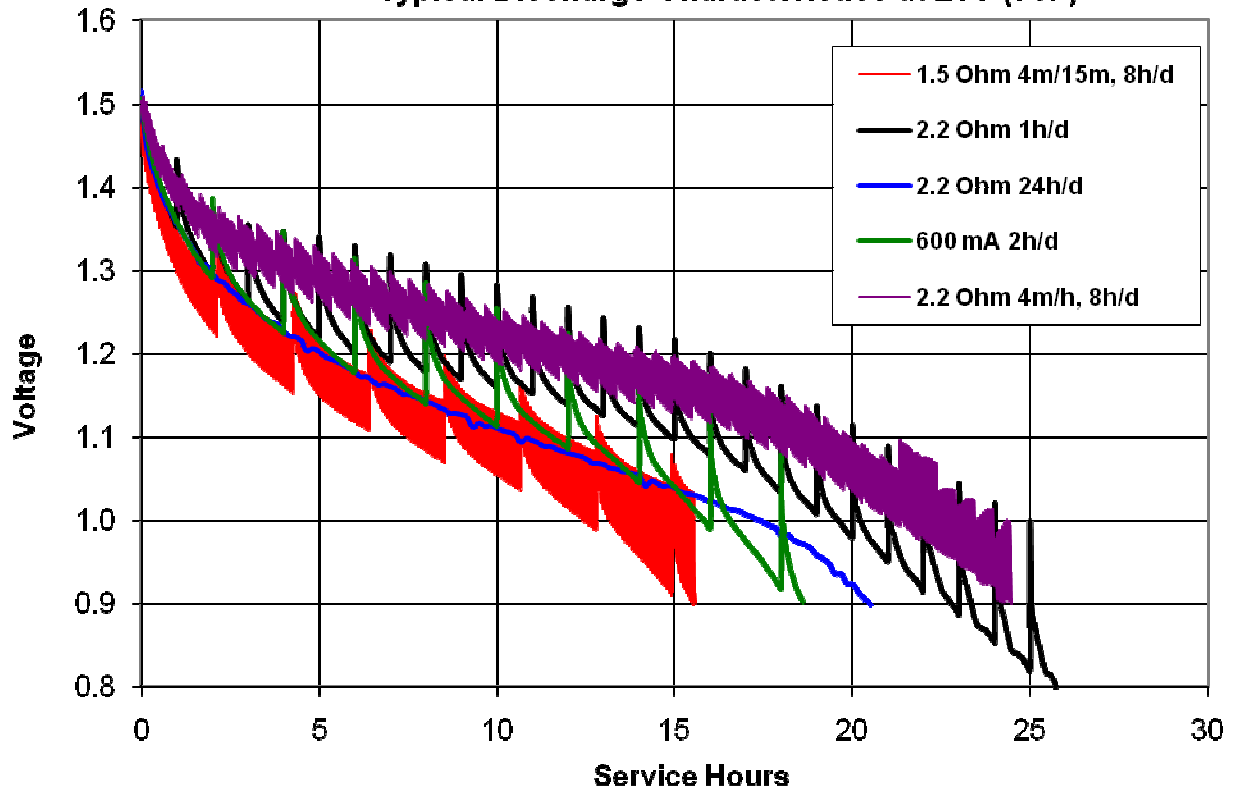

Typical Discharge Characteristics at 21C (70F) - Radio
Application: 10 Ohm 4 hrs/day

