

CoroCut® SL

Blade for grooving, parting off, profiling and turning

Screw clamp

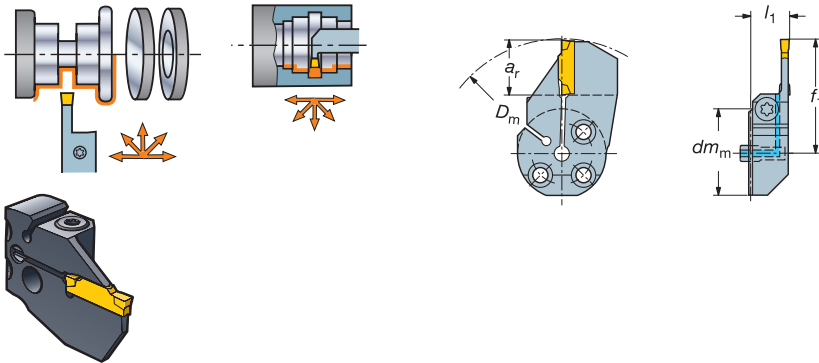

Right hand style shown

D_m min	a_r max	Seat size ¹⁾	Ordering code	Coupling size		Dimensions, mm		Gauge inserts	Nm ³⁾
				dm_m	h_1	l_1			
145	12	D	570-25R/L123D12B	25	30	14	N123D2-0150- CM	2	
145	12		570-32R/L123D12B	32	37	14	N123D2-0150- CM	2	
139	15	E	570-25R/L123E15B ²⁾	25	29.5	14	N123E2-0200- GM	2	
139	15		570-32R/L123E15B ²⁾	32	37	14	N123E2-0200- GM	2	
143	15	F	570-25R/L123F15B ²⁾	25	29.5	14	N123F2-0250- GM	2	
139	15		570-32R/L123F15B ²⁾	32	37	14	N123F2-0250- GM	2	
147	18	G	570-25R/L123G18B ²⁾	25	32.5	14	N123G2-0300- GM	3	
147	18		570-32R/L123G18B ²⁾	32	36	14	N123G2-0300- GM	3	
147	18		570-40R/L123G18B ²⁾	40	36	14	N123G2-0300- GM	3	
95	23	H	570-32R/L123H23B	32	41	18	N123H2-0400- GM	3	
95	23		570-40R/L123H23B	40	45	18	N123H2-0400- GM	3	
95	18	J	570-32R/L123J18B	32	36	18	N123J2-0500- GM	4	
95	18		570-40R/L123J18B	40	45	18	N123J2-0500- GM	3	
95	18	K	570-40R/L123K18B	40	45	18	N123K2-0600- GM	4	

¹⁾ To correspond with seat size on insert.

²⁾ When using an insert with -GF geometry, min. hole diameter (D_m) is 130 mm.

³⁾ Insert tightening torque Nm

Ordering example: 2 pieces 570-25R123D12B
570-25L123D12B

R = Right hand, L = Left hand

Main spare parts

Seat size	Coupling size	Clamping screw	Key (Torx Plus)	Coolant tube
D, E, F	25	3212 012-259	5680 043-14 (20 IP)	5691 041-01
D, E, F	32	3212 012-260	5680 043-14 (20 IP)	5691 041-01
G	25	3212 012-309	5680 043-15 (25 IP)	5691 041-01
G	32	3212 012-310	5680 043-15 (25 IP)	5691 041-01
G	40	3112 012-311	5680 043-15 (25 IP)	5691 041-01
H, J	32	3212 012-310	5680 043-15 (25 IP)	5691 041-02
H, J, K	40	3212 012-311	5680 043-15 (25 IP)	5691 041-02
K	40	3212 012-311	5680 043-15 (25 IP)	5691 041-02



CoroCut® SL

Blade for shallow grooving and face grooving

Screw clamp

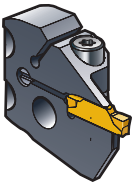
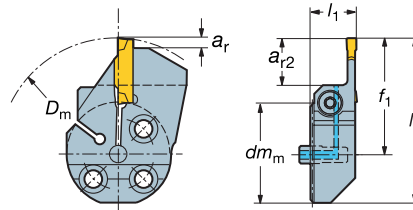
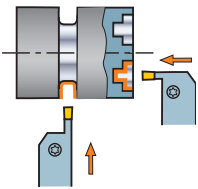

Right hand style shown

				Coupling size			Dimensions, mm				
D_m min ¹⁾	a_r max	a_{r2} max	Seat size ²⁾	Ordering code	dm_m	f_1	l_3	Gauge inserts		Nm ³⁾	
147.0	3.5	13	G	570-25R/L123G13C	25	32.6	44.1	N123G2-0300- CM		3	
147.0	3.5	13		570-32R/L123G13C	32	36.1	51.1	N123G2-0300- CM		3	
147.0	3.5	12		570-40R/L123G12C	40	39.1	58.1	N123G2-0300- CM		3	
88.0	4.5	18	J	570-32R/L123J18C	32	41.1	56.1	N123J2-0500- CM		3	
92.0	4.5	17	K	570-40R/L123K17C	40	44.1	63.1	N123K2-0600- CR		4	

1) By using geometry -GF D_m can be reduced down to 49 mm for G seat size and to 58 mm for J seat size.

2) To correspond with seat size on insert.

3) Insert tightening torque Nm

Ordering example: 2 pieces 570-25R123G13C

570-25L123G13C

R = Right hand, L = Left hand

Shallow grooving holders can take several insert sizes. Holder with seat size G can take insert E, F and G. Holders with seat size J or K can take insert size H, J and K.

Please note f_1 and l_3 dimensions above are valid when using the gauge insert.

Shallow grooving holder for face grooving

Holder seat size	Insert seat size	First cut diameter, mm	Max cutting depth, mm	First cut diameters
		min.-max.		123-GM, -TF, -CM, -RM, -TM
G	E	100 - ∞	3.5	
	F	83 - ∞	3.5	
	G	57 - ∞	3.5	
J	H	46 - ∞	4.5	
	J	46 - ∞	4.5	
	K	46 - ∞	4.5	
K	H	46 - ∞	4.5	
	J	46 - ∞	4.5	
	K	46 - ∞	4.5	

Main spare parts

			1	2	3
Seat size	Coupling size	CoroCut® SL blades	Clamping screw	Key (Torx Plus)	Coolant tube
G	25	570-25R/L123G13C	3212 012-309	5680 043-15 (25IP)	5691 041-01
G	32	570-32R/L123G13C	3212 012-310	5680 043-15 (25IP)	5691 041-01
G	40	570-40R/L123G13C	3212 012-311	5680 043-15 (25IP)	5691 041-01
J	32	570-32R/L123J18C	3212 012-310	5680 043-15 (25IP)	5691 041-02
K	40	570-40R/L123K17C	3212 012-311	5680 043-15 (25IP)	5691 041-01



CoroCut® SL

Blade for face grooving
Screw clamp

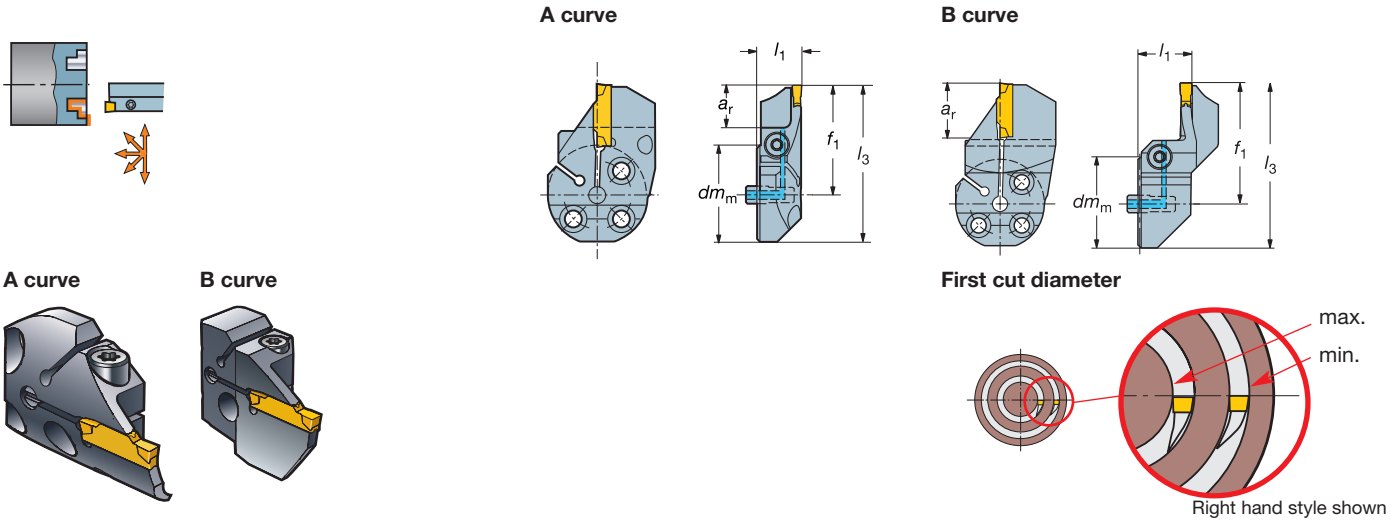

First cut diameter		Seat size 1)	A curve		B curve		Coupling size	Dimensions, mm				Gauge inserts	Nm 2)
min	max		ar	max	Ordering code	Ordering code		dm _m	l ₁	f ₁	l ₃		
40	56	12	F	570-32R/L123F12B040A	570-32R/L123F12B040B	32	14	34.4	49.35	N123F2-0250- CM	2		
54	70	12		570-32R/L123F12B054A	570-32R/L123F12B054B	32	14	34.4	49.35	N123F2-0250- CM	2		
68	98	15		570-32R/L123F15B068A	570-32R/L123F15B068B	32	14	37.4	52.35	N123F2-0250- CM	2		
90	140	15		570-32R/L123F15B090A	570-32R/L123F15B090B	32	14	37.4	52.35	N123F2-0250- CM	2		
130	300	15		570-32R/L123F15B130A	570-32R/L123F15B130B	32	14	37.4	52.35	N123F2-0250- CM	2		
34	44	12	G	570-32R/L123G12B034A	570-32R/L123G12B034B	32	18	35.1	50.1	N123G2-0300- CM	2.5		
42	60	15		570-32R/L123G15B042A	570-32R/L123G15B042B	32	18	38.1	53.1	N123G2-0300- CM	3		
54	75	15		570-32R/L123G15B054A	570-32R/L123G15B054B	32	18	38.1	53.1	N123G2-0300- CM	3		
67	100	18		570-32R/L123G18B067A	570-32R/L123G18B067B	32	18	41.1	56.1	N123G2-0300- CM	3		
90	160	18		570-32R/L123G18B090A	570-32R/L123G18B090B	32	18	41.1	56.1	N123G2-0300- CM	3		
130	300	18		570-32R/L123G18B130A	570-32R/L123G18B130B	32	18	41.1	56.1	N123G2-0300- CM	3		
40	60	18	H	570-32R/L123H18B040A	570-32R/L123H18B040B	32	18	41.1	56.1	N123H2-0400- CM	3		
52	72	18		570-32R/L123H18B052A	570-32R/L123H18B052B	32	18	41.1	56.1	N123H2-0400- CM	3		
64	100	18		570-32R/L123H18B064A	570-32R/L123H18B064B	32	18	41.1	56.1	N123H2-0400- CM	3		
92	140	18		570-32R/L123H18B092A	570-32R/L123H18B092B	32	18	41.1	56.1	N123H2-0400- CM	3		
132	230	18		570-32R/L123H18B132A	570-32R/L123H18B132B	32	18	41.1	56.1	N123H2-0400- CM	3		
220	500	18		570-32R/L123H18B220A	570-32R/L123H18B220B	32	18	41.1	56.1	N123H2-0400- CM	3		
300		18		570-32R/L123H18B300A	570-32R/L123H18B300B	32	18	41.1	56.1	N123H2-0400- CM	3		
40	70	18	J	570-32R/L123J18B040A	570-32R/L123J18B040B	32	18	41.1	56.1	N123J2-0500- CM	3.5		
60	95	18		570-32R/L123J18B060A	570-32R/L123J18B060B	32	18	41.1	56.1	N123J2-0500- CM	3.5		
85	130	18		570-32R/L123J18B085A	570-32R/L123J18B085B	32	18	41.1	56.1	N123J2-0500- CM	3.5		
120	180	18		570-32R/L123J18B120A	570-32R/L123J18B120B	32	18	41.1	56.1	N123J2-0500- CM	3.5		
175	500	18		570-32R/L123J18B175A	570-32R/L123J18B175B	32	18	41.1	56.1	N123J2-0500- CM	3.5		
180		18		570-32R/L123J18B180A	570-32R/L123J18B180B	32	18	41.1	56.1	N123J2-0500- CM	3.5		
40	70	18	K	570-32R/L123K18B040A	570-32R/L123K18B040B	32	18	41.1	56.1	N123K2-0600- CR	4		
58	100	18		570-32R/L123K18B058A	570-32R/L123K18B058B	32	18	41.1	56.1	N123K2-0600- CR	4		
88	180	18		570-32R/L123K18B088A	570-32R/L123K18B088B	32	18	41.1	56.1	N123K2-0600- CR	4		
168	400	18		570-32R/L123K18B168A	570-32R/L123K18B168B	32	18	41.1	56.1	N123K2-0600- CR	4		
220		18		570-32R/L123K18B220A	570-32R/L123K18B220B	32	18	41.1	56.1	N123K2-0600- CR	4		

1) To correspond with seat size on insert.
2) Insert tightening torque Nm

Ordering example: 2 pieces 570-32R123F12B040A
570-32L123F12B040A
R = Right hand, L = Left hand

Main spare parts

Seat size	Coupling size	Screw	Key (Torx Plus)	Coolant tube
F	32	3212 012-260	5680 043-14 (20IP)	5691 041-01
G		3212 012-310	5680 043-15 (25IP)	5691 041-01
H, J, K		3212 012-310	5680 043-15 (25IP)	5619 041-02



T-Max Q-Cut® SL

Blade for grooving and parting

Spring clamp

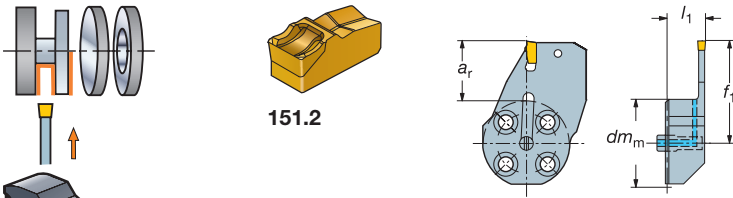

151.2

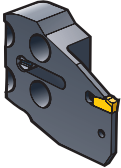

These T-Max Q-Cut® SL blades can only accept the 151.2 inserts

a_r max	Seat size ¹⁾	Ordering code	Coupling size		Dimensions, mm		Gauge inserts
			dm_m	f_1	l_1		
20	20	570-25R/L151.21-20-20	25	34.1	14		N151.2-200- 5E
20		570-32R/L151.21-20-20	32	37.6	14		N151.2-200- 5E
20	25	570-25R/L151.21-20-25	25	34.1	14		N151.2-250- 5E
20		570-32R/L151.21-20-25	32	37.6	14		N151.2-250- 5E
30	30	570-25R/L151.21-30-30	25	44.1	14		N151.2-300- 5E
30		570-32R/L151.21-30-30	32	47.6	14		N151.2-300- 5E
30	40	570-32R/L151.21-32-40	32	47.6	14		N151.2-400- 5E
32		570-40R/L151.21-32-40	40	53.6	14		N151.2-400- 5E
32	50	570-32R/L151.21-32-50	32	49.6	14		N151.2-500- 5E
32		570-40R/L151.21-32-50	40	53.6	14		N151.2-500- 5E

¹⁾ To correspond with seat size on insert.

Ordering example: 2 pieces 570-25R151.21-20-20
570-25L151.21-20-20
R = Right hand, L = Left hand

Main spare parts

Seat size	Delivery to separate order	
	Coolant tube	Insert key
20, 25, 30	5691 041-01	5680 057-021570
40, 50	5691 041-03	5680 057-011



B 70

T-Max Q-Cut® SL

Blade for internal grooving and profiling

Screw clamp

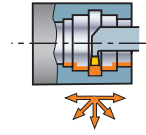

151.3

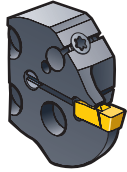
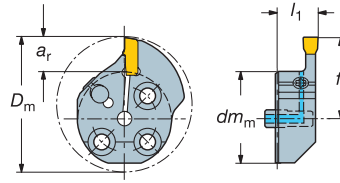

These T-Max® Q-Cut® SL blades can only accept the 151.3 inserts

First cut diameter		Seat size ¹⁾	Coupling size	Dimensions, mm			Gauge inserts	Nm ²⁾
D_m min	a_r max			Ordering code	dm_m	f_1		
35.6	8	20	570-25R/L151.3-08-20	25	22.1	14	N151.3-200-20- 4G	3
42.6	8		570-32R/L151.3-08-20	32	25.6	14	N151.3-200-20- 4G	3
40	8	25	570-25R/L151.3-08-25	25	22.1	14	N151.3-300-25- 7G	3
41.6	7		570-32R/L151.3-07-25	32	24.6	14	N151.3-300-25- 7G	3
40.7	8	30	570-25R/L151.3-08-30	25	22.1	14	N151.3-300-30- 4G	3
42.6	8		570-32R/L151.3-08-30	32	25.6	14	N151.3-300-30- 4G	3
48.6	8		570-40R/L151.3-06-30	40	22.1	18	N151.3-300-30- 4G	3
51.6	9	40	570-40R/L151.3-09-40	40	26.6	18	N151.3-500-40- 7G	3
48	10		570-32R/L151.3-10-40	32	27.6	18	N151.3-500-40- 7G	3
51.6	9	50	570-40R/L151.3-09-50	40	26.6	18	N151.3-600-50- 7G	3
48.8	10		570-32R/L151.3-10-50	32	27.6	18	N151.3-600-50- 7G	3
47.6	13	60	570-32R/L151.3-13-60	32	30.6	18	N151.3-800-60- 4G	3
54.6	12		570-40R/L151.3-12-60	40	29.6	18	N151.3-800-60- 4G	3

¹⁾ To correspond with seat size on insert.

²⁾ Insert tightening torque Nm

Ordering example: 2 pieces 570-25R151.3-08-20

570-25L151.3-08-20

R = Right hand, L = Left hand

Main spare parts

Seat size	Clamping screw	Key (Torx Plus)	Clamping nut	Coolant tube
20, 25	5513 017-02	5680 049-02 (15IP)	5534 021-01	5691 041-01
30, 40, 50, 60-	5513 017-02	5680 049-02 (15IP)	5534 021-01	5691 041-03



B6



B102



B2

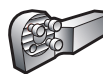

B73



A199

T-Max Q-Cut® SL

Blade for face grooving

Screw clamp

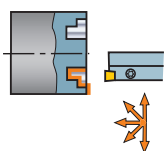

151.3

A curve

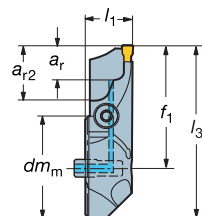
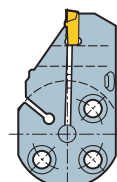

B curve

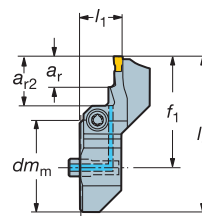
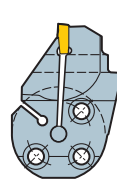

A curve

B curve

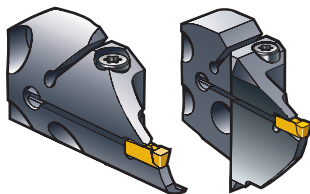

These T-Max Q-Cut® SL blades can only accept the 151.3 inserts

First cut diameter

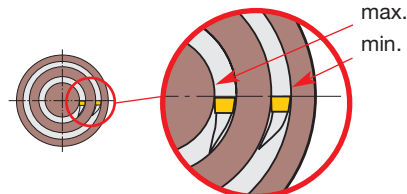

Right hand style shown

First cut diameter		a_{r2} max	Seat size ¹⁾	A curve	B curve	Coupling size	Dimensions, mm			Gauge inserts	Nm ²⁾
min	max			Ordering code	Ordering code		d_{m_m}	l_1	f_1		
24	35	15	25	570-32R/L151.3-024A25	570-32R/L151.3-024B25	32	14	37.4	52.35	N151.3-300-25- 7G	2
29	40	15		570-32R/L151.3-029A25	570-32R/L151.3-029B25	32	14	37.4	52.35	N151.3-300-25- 7G	2
27	45	20	30	570-32R/L151.3-027A30	570-32R/L151.3-027B30	32	14	43.1	58.1	N151.3-400-30- 7G	3.5
32	50	20		570-32R/L151.3-032A30	570-32R/L151.3-032B30	32	14	43.1	58.1	N151.3-400-30- 7G	3.5
25	45	20	40	570-32R/L151.3-025A40	570-32R/L151.3-025B40	32	18	43.1	58.1	N151.3-500-40- 7G	3.5
30	55	20		570-32R/L151.3-030A40	570-32R/L151.3-030B40	32	18	43.1	58.1	N151.3-500-40- 7G	3.5
23	45	18	50	570-32R/L151.3-023A50	570-32R/L151.3-023B50	32	18	41.1	56.1	N151.3-600-50- 7G	4
38	70	18		570-32R/L151.3-038A50	570-32R/L151.3-038B50	32	18	41.1	56.1	N151.3-600-50- 7G	4

¹⁾ To correspond with seat size on insert.

²⁾ Insert tightening torque Nm

Ordering example: 2 pieces 570-32R151.3-024A25

570-32L151.3-024A25

R = Right hand, L = Left hand

Main spare parts

Seat size	Coupling size	Screw	Key (Torx Plus)	Coolant tube
25	32	3212 012-260	5680 043-14 (20IP)	5691 041-01
30		3212 012-310	5680 043-15 (25IP)	5691 041-03
40		3212 012-310	5680 043-15 (25IP)	5619 041-02
50		3212 012-310	5680 043-15 (25IP)	5691 041-02

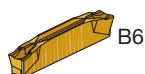

B6



B102



B2

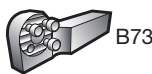

B73



A199

CoroTurn® SL

Coromant Capto® adapter

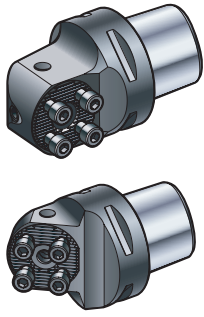

Coromant Capto® 0°

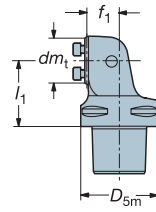

Coromant Capto® 45°

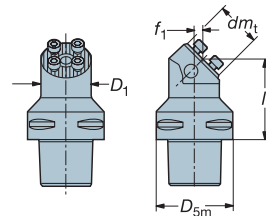

Coromant Capto® 90°

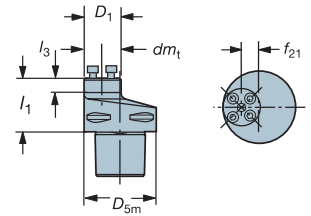

Right hand style shown

Blades for adapters		Ordering code	Coupling Dimensions, mm size							
CoroCut® SL blade	T-Max Q-Cut® SL blade		dm_t	D_{5m}	D_1	f_1	f_{21}	l_1	l_2	l_3
0°										
570-25R/L123	570-25R/L151.21	C3-570-25-R/LF	25	32		8		33.5	65	
570-25R/L123	570-25R/L151.21	C4-570-25-R/LF	25	40		13		37	74	
570-32R/L123	570-32R/L151.21	C4-570-32-R/LF	32	40		13		43.5	84	
570-40R/L123	570-40R/L151.21	C4-570-40-R/LF	40	40		13		48.5	93	
570-25R/L123	570-25R/L151.21	C5-570-25-R/LF	25	50		21		36	79	
570-32R/L123	570-32R/L151.21	C5-570-32-R/LF	32	50		21		42	88	
570-40R/L123	570-40R/L151.21	C5-570-40-R/LF	40	50		21		46	96	
570-25R/L123	570-25R/L151.21	C6-570-25-R/LF	25	63		31		34	85	
570-32R/L123	570-32R/L151.21	C6-570-32-R/LF	32	63		31		38.5	93	
570-40R/L123	570-40R/L151.21	C6-570-40-R/LF	40	63		31		42.5	101	
570-32R/L123	570-32R/L151.21	C8-570-32-R/LF	32	80		41		46	110	
570-40R/L123	570-40R/L151.21	C8-570-40-R/LF	40	80		41		50	118	
45°										
570-25R/L123	570-25R/L151.21	C5-570-25-R/LX-045	25	50		8		34.5	76	
570-32R/L123	570-32R/L151.21	C5-570-32-R/LX-045	32	50		6		34	78	
570-32R/L123	570-32R/L151.21	C5-570-32-RX-045-L1	32	50		2		90	120	
570-25R/L123	570-25R/L151.21	C6-570-25-R/LX-045	25	63		14.5		36	86	
570-32R/L123	570-32R/L151.21	C6-570-32-R/LX-045	32	63		12.5		37.5	90	
570-32R/L123	570-32R/L151.21	C6-570-32-RX-045-L1	32	63		2		100	138	
570-40R/L123	570-40R/L151.21	C6-570-40-RX-045-L1	32	63		2		100	138	
570-40R/L123	570-40R/L151.21	C8-570-40-RX-045-L1	40	80		5		135	120	
90°										
570-32R/L123	570-32R/L151.21	C3-570-32-NG	32	32	32			22	41	
570-32R/L123	570-32R/L151.21	C4-570-32-NG	32	40	32			32	56	8
570-32R/L123	570-32R/L151.21	C5-570-32-R/LG	32	50	32		9	42	72	15
570-40R/L123	570-40R/L151.21	C5-570-40-NG	40	50	40			42	72	12
570-32R/L123	570-32R/L151.21	C6-570-32-R/LG	32	63	32		15.5	47	85	14
570-40R/L123	570-40R/L151.21	C6-570-40-NG	40	63	40			47	85	16
570-40R/L123	570-40R/L151.21	C8-570-40-R/LG	40	80	40		20	62	110	26

Ordering example: 2 pieces C3-570-25-RF
C3-570-25-LF
R = Right hand, L = Left hand



CoroTurn® SL

Shank adapter

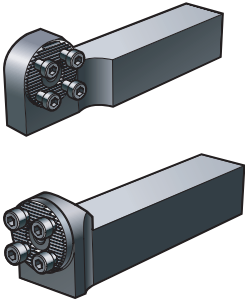

0°
570-25-RF

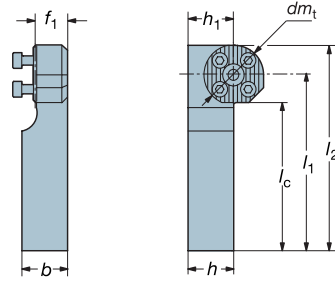

Right hand style shown

90°
570-25-NG

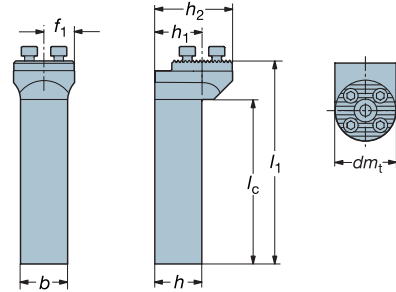

Neutral

Blades for adapters		Coupling size	Dimensions, mm								
CoroCut® SL blade	T-Max Q-Cut® SL blade		dm_t	b	h	h_1	h_2	f_1	l_1	l_2	l_c
			0°								
570-25R/L123	570-25R/L151.21	570-25R/LF-2020	25	20	20	20		15	94	107	83
570-32R/L123	570-32R/L151.21	570-32R/LF-2020	32	20	20	20		18	98	114	83
570-25R/L123	570-25R/L151.21	570-25R/LF-2525	25	25	25	25		18	119	132	108
570-32R/L123	570-32R/L151.21	570-32R/LF-2525	32	25	25	25		18	116	132	101
570-32R/L123	570-32R/L151.21	570-32R/LF-3232	32	32	32	32		26	136	152	121
570-40R/L123	570-40R/L151.21	570-40R/LF-3232	40	32	32	32		26	134	154	115
			90°								
570-25R/L123	570-25R/L151.21	570-25NG-2020	25	20	20	20	32.6	9.98	111		91
570-32R/L123	570-32R/L151.21	570-32NG-2020	32	20	20	20	36.2	9.98	103		83
570-25R/L123	570-25R/L151.21	570-25NG-2525	25	25	25	25	37.6	12.48	132		112
570-32R/L123	570-32R/L151.21	570-32NG-2525	32	25	25	25	37.6	12.48	132		112
570-32R/L123	570-32R/L151.21	570-32NG-3232	32	32	32	32	48.2	15.98	152		132
570-40R/L123	570-40R/L151.21	570-40NG-3232	40	32	32	32	52.2	15.98	152		132

Ordering example: 2 pieces 570-25RF-2020
570-25LF-2020

R = Right hand, L = Left hand



T-Max U-Lock® grooving

For economical circlip grooving and machining of shallow grooves



- Sharp cutting edges giving high quality grooves
- For both external and internal grooves
- Grooving widths from 1.10 mm to 4.15 mm
- Bores down to 12 mm
- One grade, GC1020, for all materials
- Easy to identify with groove widths pressed into the insert

To be used in T-Max U-Lock® toolholders with shim giving 0° inclination angle.

Speed recommendations

Material



Cutting speed Start values

v_c m/min (CMC No.)	125 (02.1)	130 (05.21)	105 (08.2)	435 (30.21)	13 (20.22)	125 (04.1)
--------------------------	---------------	----------------	---------------	----------------	---------------	---------------

T-Max U-Lock® for circlip grooving

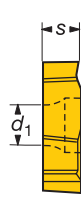
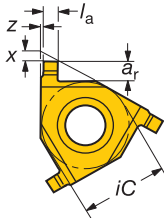

\triangle	iC	d_1	s
11	6.35	2.8	3.17
16	9.525	4.4	3.97
22	12.7	5.5	5.56

Tolerances, mm:

$$l_a = +0.13$$

$$+0.05$$

$$s = \pm 0.13$$

Note!

The right hand insert can be used for right hand external and left hand internal holders, and the left hand insert for left hand external and right hand internal holders.

Selection criteria, mm		\triangle	Dimensions, mm				-
l_a	a_r	Seat size	Ordering code	x	z	r_ϵ	1020
1.10	0.7	11	L154.0G-11CC01-110	0.7	0.05	0.08	☆
1.10	1.3	16	R/L154.0G-16CC01-110	1.35	0.05	0.08	☆
1.30	1.6		R/L154.0G-16CC01-130	1.35	0.05	0.08	☆
1.60	1.85		R/L154.0G-16CC01-160	1.35	0.05	0.08	☆
1.85	1.85		R/L154.0G-16CC01-185	1.35	0.05	0.08	☆
2.15	1.85		R/L154.0G-16CC01-215	1.35	0.05	0.08	☆
1.85	2.2	22	R/L154.0G-22CC01-185	1.7	0.05	0.08	☆
2.15	2.2		R/L154.0G-22CC01-215	1.7	0.05	0.08	☆
2.65	2.2		R/L154.0G-22CC01-265	1.7	0.05	0.15	☆
3.15	2.2		R/L154.0G-22CC01-315	1.7	0.05	0.15	☆
4.15	2.6		R/L154.0G-22CC01-415	1.65	0.05	0.15	☆

Ordering example: 10 pieces R154.0G-16CC01-110

L154.0G-16CC01-110

R = Right hand, L = Left hand



C6

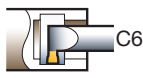

C6

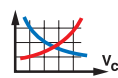

B118



GC

B122



B2

This catalogue has been split into smaller parts
to enhance downloading speeds.

If you want to view the next page
please click [HERE!](#)