

SH. 1
OF 1

CAT NO

70A

CUSTOMER DIMENSIONS

DO NOT
SEPARATE
PRINT FROM
WORK

LOT NO

OPER

TOOLS

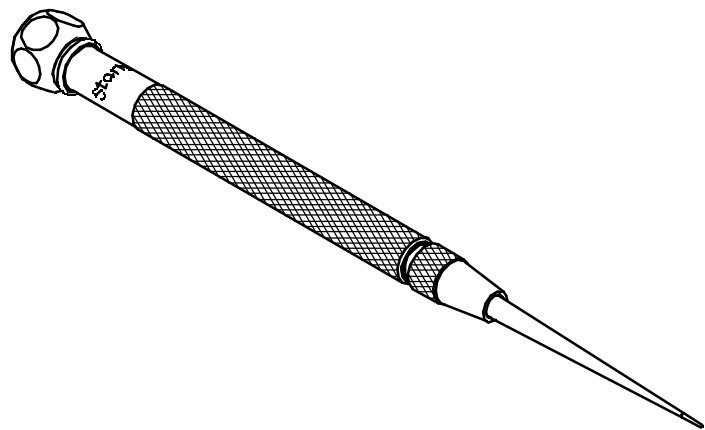
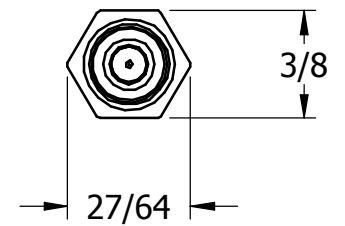
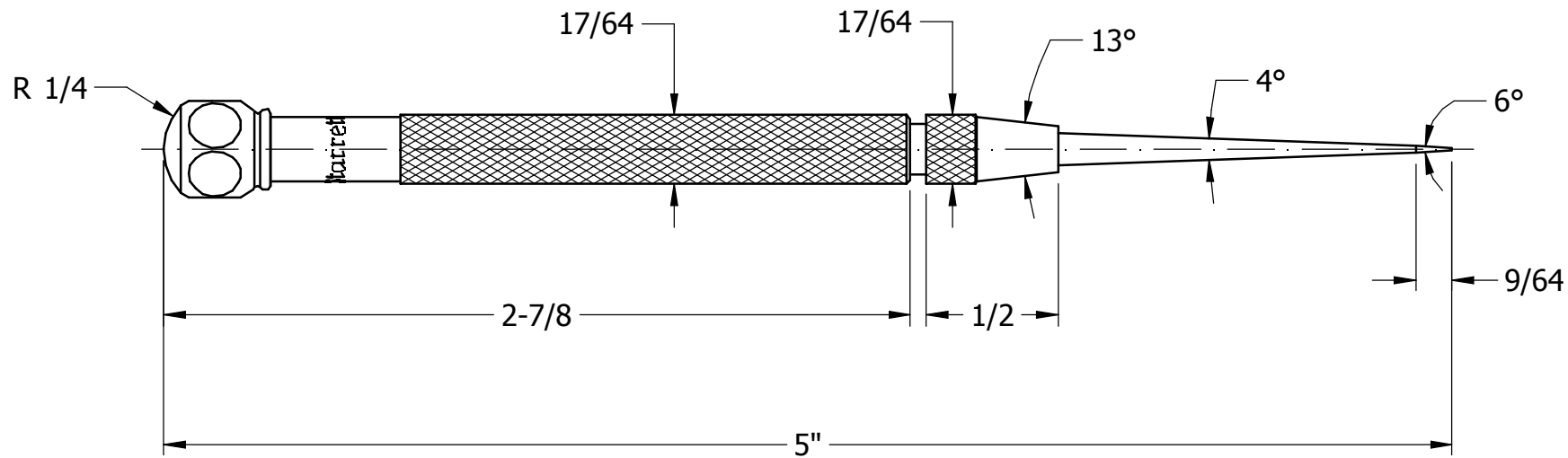
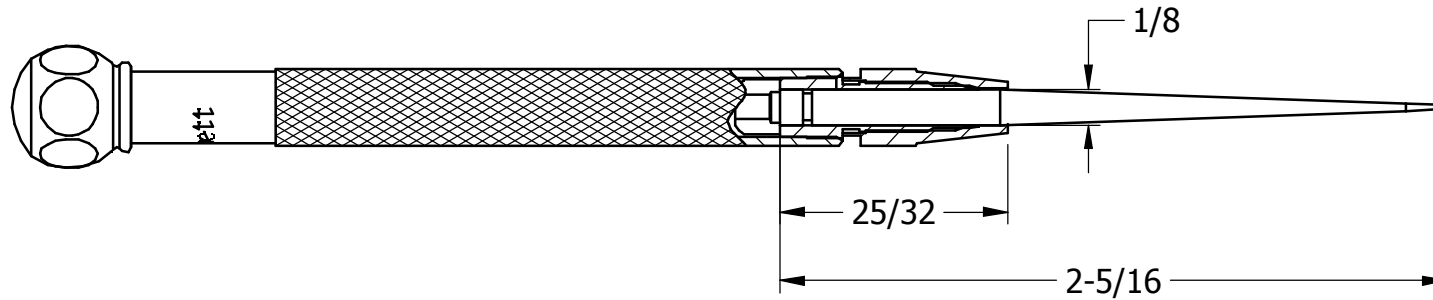

REV	DESCRIPTION	DATE	BY
DR	HLS	CHK	DATE

POCKET SCIBER
ASSEMBLY

THE L.S. STARRETT CO.
ATHOL, MASS.

FRACTIONAL TOLERANCE +- 1/64 UNLESS OTHERWISE NOTED