

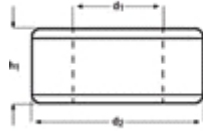

2710M

Adjustable Dies



M	P mm	d ₂ R Inch	h ₁ Inch	e-code	USD
2	0.40	13/16	1/4	2710M2X.4X13/16	70.10
2.5	0.45	13/16	1/4	2710M2.5X.45X13/16	70.10
3	0.50	13/16	1/4	2710M3X.5X13/16	70.10
4	0.70	13/16	1/4	2710M4X.7X13/16	70.10
4.5	0.75	13/16	1/4	2710M4.5X.75X13/16	70.10
5	0.80	13/16	1/4	2710M5X.8X1	70.10
6	1.00	1"	3/8	2710M6X1.0X1	87.40
8	1.25	1"	3/8	2710M8X1.25X1	87.40
9	1.25	1"	3/8	2710M9X1.25X1	87.40
10.0	1.50	1"	3/8	2710M10X1.5X1	87.40
12	1.75	1"	3/8	2710M12X1.75X1	87.40
12	1.75	1.1/2	1/2	2710M12X1.75X1.1/2	140.00
14	2.00	1.1/2	1/2	2710M14X2.0X1.1/2	140.00
16	2.00	1.1/2	1/2	2710M16X2.0X1.1/2	140.00
18	2.50	2"	5/8	2710M18X2.5X2	240.00
20	2.50	2"	5/8	2710M20X2.5X2	240.00